

YU-USB Waterproof Data Connector

Linko professional multi-functional YU-USB data waterproof connector and panel mount be used for data transmission, because of plug and play, fast transmission rate, strong scalability characteristics, are widely used in computers, digital cameras, scanners and other data transmission equipment, this series of products are diverse, can achieve male-female conversion docking, independent base, male-head belt line, etc.

Application Types:

Data: USB

Data Type : USB2.0- USB3.0

Data connection withstands voltage 100V/Min, contact resistance 30m/Max, optional data transmission level.

- Data
USB Cable Range : $\phi 5.5 \sim \phi 6.5 \text{mm}$

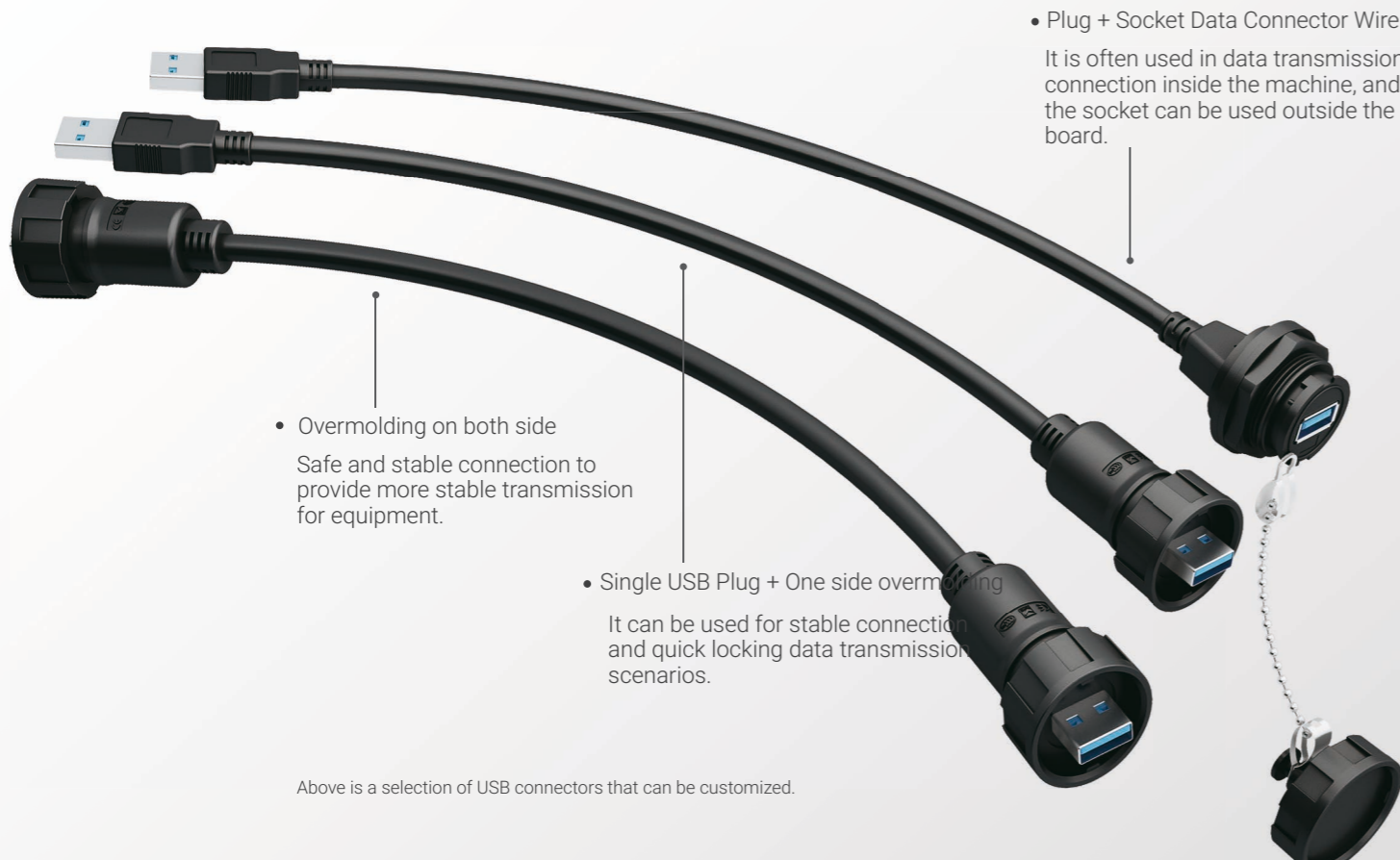

• Plug + Socket Data Connector Wire.
It is often used in data transmission connection inside the machine, and the socket can be used outside the board.

• Overmolding on both side
Safe and stable connection to provide more stable transmission for equipment.

• Single USB Plug + One side overmolding
It can be used for stable connection and quick locking data transmission scenarios.

Above is a selection of USB connectors that can be customized.

Main Advantage :

- Independent socket design, no tool assistance, easy installation, easy operation;
- The utility model can realize double-head transfer between male and female, and the clamp is locked and secure;
- Unique docking design, stable extension of infinite length of wire;
- Strong connection system provides solutions for data connection and transmission in different environments.
- The product meets IP67 protection level in mated condition.

Characteristics



Reliable waterproof performance

- The protection level under connection state reaches IP67, which provides good electrical protection performance for equipment.



Multiple connection modes

- Product diversity, with the transmission level products can be flexibly collocated with use.



Clasp locking

- The sockets and rubber-covered plugs are securely and securely fastened by a firm jacket clamp.

• **Multiple connection modes**



Design of cable sheath

- Plug and socket end adopt cable sheath design to effectively protect cable outlet



Panel Installation



In line connection

Data Sheet

Data	Product Series	YU-USB2.0			YU-USB3.0		
	Current Rating	—			—		
	Voltage Rating	—			—		
	Cable range	Ø5.5~Ø6.5mm			Ø5.5~Ø6.5mm		
	Wire Gauge	26-24AWG			26-24AWG		
	IP Protection Class (Mated)	IP67 (Mated)			IP67 (Mated)		
	Termination	Bayonet			Bayonet		
		USB2.0 (Cable length 1 meter)			USB3.0 (Cable length 1 meter)		
Product Picture	Overmolding one side 	Overmolding both side 	Overmolding both side 	Overmolding one side 	Overmolding both side 	Male Plug + Female panel mount 	
Part Number	YU-USB2-CPI-01-100	YU-USB2-CPI-02-100	YU-USB2-JSX-11-100	YU-USB3-CPI-01-100	YU-USB3-CPI-02-100	YU-USB3-FP-MP-012	
Product Picture	Male Plug + Female panel mount 	Male Plug + Female panel mount 	Overmolding one side + Printer reel 	Double Panel Mount 	Female Panel Mount with 9 pin for PCB 	Female Panel Mount 	
Part Number	YU-USB2-FP-MP-022	YU-USB2-JSX-03-100	YU-USB2-CPI-03-100	YU-USB3-JSX-02-100	YU-USB3-JSX-03-001	YU-USB3-JSX-01-001	
Product Picture	Female Panel mount with Metal Chain 	Female Panel Mount 	Female Panel Mount + 90 Degree Plug 	Female Panel mount with Metal Chain 	Female Panel mount + Overmolding one side 	—	
Part Number	YU-USB2-JSX-04-001	YU-USB2-JSX-01-003	YU-USB2-JSX-09-100	YU-USB3-JSX-01-100	YU-USB3-JSX-04-100	—	
Product Picture	Female Panel Mount with 4 pin for PCB 	Female Panel Mount with 5 pin for PCB 	—	—	—	—	
Part Number	YU-USB2-JSX-02-001	YU-USB2-JSX-17-001	—	—	—	—	

Appearance Dimension

■ USB Cable connector

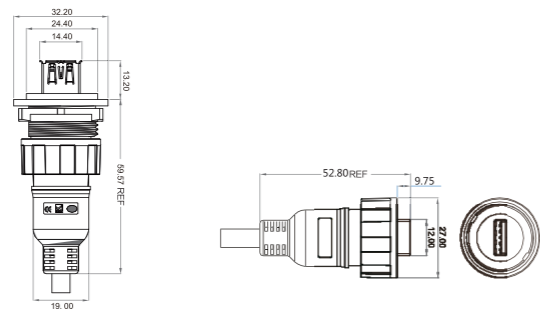

■ USB Panel Mounting

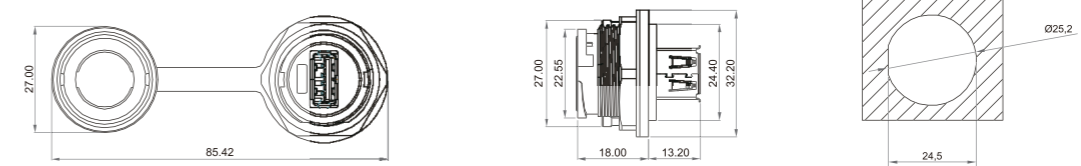

YU-USB