



YA-20-C03PE-03-001  
公头 Male plug



YA-20-J03SX-01-001  
母座 Female socket



防水胶垫 Waterproof cushion

- 多款式的内芯设计（2-12芯），符合多样性的工业需求。
- 锌合金的座子及内部构件材质，具有完整的电磁及射频干扰保护。
- 镀金触点，高强的耐腐蚀性及导电性，有效应对电流产生的温升变化。
- PBT材质外壳，稳定的电气性能，高强的抗耐压，抗高温，抗爆，抗腐蚀性。
- 电源（7芯以下）及信号（12芯）同时兼容匹配。
- 防护等级IP65/IP67。
- 20A rms 的额定电流。
- 1/4卡口快速连接。

- Multi-core design styles (2-12 cores), in line with industry needs diversity
- Socket and internal components zinc alloy material, with a complete electromagnetic and radio frequency interference protection
- Gold-plated contacts, high-strength corrosion resistance and electrical conductivity, effective response to temperature changes in current
- PBT material shell, stable electrical performance, high strength and resistance to pressure, high temperature resistance, anti-explosion, anti-corrosive
- Power (7 cores or less) and signal (12 cores) compatible match
- Protection level IP65/IP67
- 20A rms rated current
- 1/4 bayonet connector



防尘防水盖 Dustproof and Protective cover



锌合金内牙及镀金铜针触点  
Zinc alloy thread and gold-plated copper contact

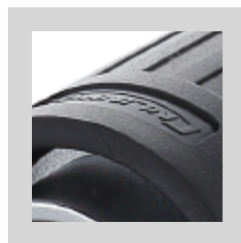

1/4卡口快速连接  
1/4 bayonet connector

# YA-20 系列产品规格参数表

## YA-20 SERIES SPECIFICATIONS SHEET

芯数 PINS		2芯 2PINS	3芯 3PINS	4芯 4PINS
<b>产品图</b> PICTURE	正装 Male plug & Female socket	 YA-20-C02PE-03-001 公头 male plug	 YA-20-C03PE-03-001 公头 male plug	 YA-20-C04PE-03-001 公头 male plug
		 YA-20-J02SX-01-001 母座 female socket	 YA-20-J03SX-01-001 母座 female socket	 YA-20-J04SX-01-001 母座 female socket
		反装 Female plug & Male socket	 YA-20-J02PE-03-001 母头 female plug	 YA-20-J03PE-03-001 母头 female plug
		 YA-20-C02SX-01-001 公座 male socket	 YA-20-C03SX-01-001 公座 male socket	 YA-20-C04SX-01-001 公座 male socket
	排列图			
	线材规格	Cable specification	2.5mm <sup>2</sup> ~ 4mm <sup>2</sup> / 14 ~ 12 AWG	
线径范围	Diameter range	Φ8mm ~ Φ12mm		
接触件直径×数量	Contact diameter × number	Φ2.7×2	Φ2.7×3	Φ2.7×4
额定电流(A)	Rated Current (A)	20A		
工作电压(AC.V.RMS)	Operating voltage (AC.V.rms)	500V		
接触电阻	Contact resistance	<1mΩ		
温升	Temperature rise	20A时温升在30℃以下 (20A contact temperature below 30℃), 25A.....40℃, 30A.....50℃.		
耐电压(AC.V)1分钟	Withstanding Voltage (AC.V) 1 minute	2500V		
绝缘电阻	Insulation resistance	> 500MΩ		
防护等级	Protection level	IP65/IP67		
耐久次数	Durability	> 500次		
工作温度	Working temperature	-40℃ ~ 80℃		
连接方式	connecting mode	1/4快速卡口连接 1/4 Bayonet connector		
接线方式	assembly wire	焊接式 solder		
<b>材料</b>				
外壳、绝缘部件	Housing, the insulating parts	高性能工程塑料	High-performance engineering plastics	
五金	Hardware	锌合金(珍珠硬铬)	Zinc Alloy (pearl hard chrome)	
铜针	Copper needles	铜合金(镀金4U)	Copper alloy (gold-plated 4U)	
防水圈	Waterproof circle	硅胶	Silica gel	
阻燃等级	Flammability rating	UL94-V0	UL94-V0	

5芯 5PINS	7芯 7PINS	9芯 9PINS	12芯 12PINS
----------	----------	----------	------------



YA-20-C05PE-03-001  
公头 male plug



YA-20-C07PE-03-001  
公头 male plug



YA-20-C09PE-03-001  
公头 male plug



YA-20-C12PE-03-001  
公头 male plug



YA-20-J05SX-01-001  
母座 female socket



YA-20-J07SX-01-001  
母座 female socket



YA-20-J09SX-01-001  
母座 female socket



YA-20-J12SX-01-001  
母座 female socket



YA-20-J05PE-03-001  
母头 female plug



YA-20-J07PE-03-001  
母头 female plug



YA-20-J09PE-03-001  
母头 female plug



YA-20-J12PE-03-001  
母头 female plug



YA-20-C05SX-01-001  
公座 male socket



YA-20-C07SX-01-001  
公座 male socket



YA-20-C09SX-01-001  
公座 male socket



YA-20-C12SX-01-001  
公座 male socket



1.0m <sup>2</sup> ~ 1.5m <sup>2</sup> / 18 ~ 16 AWG		0.15m <sup>2</sup> ~ 0.2m <sup>2</sup> / 26-24 AWG	
Φ7mm ~ Φ9mm		Φ5.5mm ~ Φ7mm	
Φ2.0×5	Φ2.0×7	Φ1.0×9	Φ1.0×12
12A		5A	
500V		400V	
<2.5mΩ		<5mΩ	
12A.....30°C I, 15A.....40°C I, 20A.....50°C I.		/	
2500V		1500V	
> 500MΩ			
IP65/IP67			
> 500次			
-40°C ~ 80°C			
1/4快速卡口连接 1/4 Bayonet connector			
焊接式		solder	
高性能工程塑料		High-performance engineering plastics	
锌合金(珍珠硬铬)		Zinc Alloy (pearl hard chrome)	
铜合金(镀金2U)		Copper alloy (gold-plated 2U)	
硅胶		Silica gel	
UL94-V0		UL94-V0	

## 型号标志代号 MODEL CODE



## 连接方式 CONNECTION SCHEMES



## 外形尺寸图 DIMENSION FIGURE

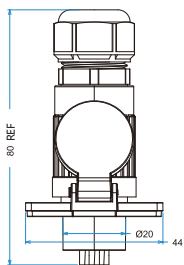

产品外型尺寸图  
dimensions figure

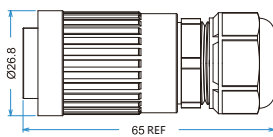

夹爪紧固式插头PE (外型尺寸图)  
PE clamping cable plug  
( dimensions figure )

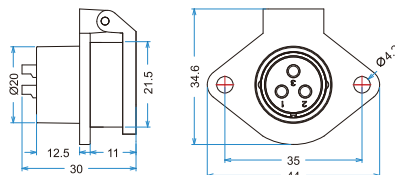

插座 SX (外型尺寸图)  
SX socket ( dimensions figure )

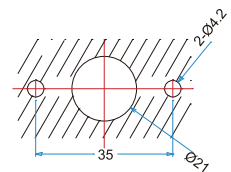

安装开孔图  
Installation hole figure